

HOMCOM

Trail Camera

Check out warranty policy at www.tovendor.com/warranty for more details. Your satisfaction is the objective which we serve. Please feel free to contact us if any questions.

Shenzhen Aosom E- commerce Co., Ltd
Site: www.tovendor.com Email: service@tovendor.com

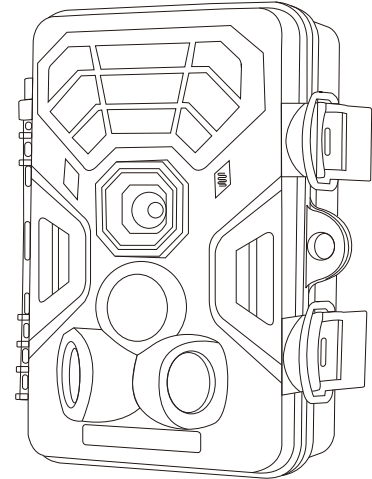

Instruction Manual



Contents

1. PACKING LIST	01
2. HAZARD, SAFETY AND WRNING NOTICES	01
3. INSTRODUCTION	03
4. STRUCTURE	04
5. PREPARING THE CAMERA	06
6. USING THE CAMERA AND SETUP MENU	08
6.1 Using the camera	08
6.2 Setup menu	10
7. ENTERING AUTOMATIC MONITORING.....	15
7.1 Adjusting and installing the camera.....	15
7.2 Setting up the live mode.....	16
8. CONNECTION TO COMPUTER	17
9. TECHINCAL SPECIFICATION	18
10. SIMPLE TROUBLESHOOTING	19
11. SYSTEM INFORMATION, MAINTENANCE AND DISPOSAL	20
11.1 Care	20
11.2 Storage	20
11.3 Disposal.....	21
12. FCC STATEMENT	21

Dear customer, congratulations on purchasing a quality product.

You have purchased a modern Trail Camera with excellent technical features and respective accessory that is particularly easy to operate. Please study all notices carefully and diligently. Please study this information in detail, especially the safety instructions.

The camera complies with CE, FCC and RoHs standard.

1. PACKING LIST

Please carefully unpack camera and check that below accessories are contained in the box.

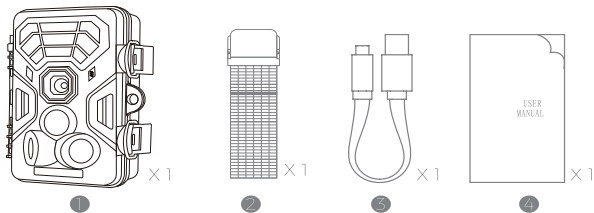

1. Wildlife Camera
2. Mounting Belt
3. USB cable
4. Instruction Manual

2. HAZARD, SAFETY AND WARNING NOTICES

Incorrect use of the camera and accessories can be dangerous for you and others and can damage or destroy the camera. We therefore ask you to read and strictly observe the following Hazard, safety and warning notices.

Intended Use

1. The camera, accessory and packaging are not toys for children. These should therefore always be kept away from children in case of danger of electrocution, poisoning and suffocation.
2. The camera and accessory may not be used by children and persons with limited abilities. The camera may only be operated by persons physically and mentally able to operate it safely.

Electrical Hazard

1. Switch off the camera and remove the batteries if a foreign body or liquid has entered the camera. Let all parts dry thoroughly. Otherwise, there exists danger of fire or electrocution.
2. Switch off the camera and remove the batteries if the camera has been dropped or the housing is damaged. Otherwise, there exists danger of fire and electrocution.
3. The camera may not be dismantled, modified or repaired. Otherwise, there exists danger of fire and electrocution.
4. Only a power adaptor (not supplied) with the mains voltage specified on the rating plate (6V) can be used. Otherwise, there exists danger of fire or electrocution. Disconnect the power by pulling the power adaptor out of the socket.
5. A plugged in power adaptor (not supplied) can continue to use power, but protect it from a hazard source.
6. The power supply may not be used during thunderstorms. Otherwise, there exists danger of electrocution.

Damage From Heat-Fire Hazard

1. Do not leave the camera in places that are susceptible to considerable increases in temperature (e.g. a vehicle). The housing and internal parts may be damaged, which in turn could cause a fire.
2. Do not wrap up camera or place it on textile. This could produce a build-up of heat in the camera that can cause deformation of the housing and may represent a fire hazard.

Injuries And Material Damage

1. Only place the camera on sturdy surfaces. The camera could otherwise fall or topple over, causing damage or injury.
2. Do not operate the camera while running or driving. You could fall or cause a traffic accident.
3. Only a mains adaptor (not supplied), whose input voltage specified on the rating plate(6V) can be used for the camera. We do not accept any liability for damage caused by the incorrect use mains adaptor.
4. The 230V socket used for the mains adaptor (not supplied) must not be covered and accessible at all time so that the mains adaptor can be quickly disconnected from the mains, when required.
5. Ensure adequate ventilation and do not cover the mains adaptor (not supplied) to avoid overheating.

- Do not place any ignition sources, such as lit candles onto or close to the device. Do not subject the LCD monitor to impact or pressure. This could damage the glass of the monitor or the liquid could leak from the inside. In case of contact with eyes or skin, rinse immediately with clear water. In case of contact with eyes, contact a doctor immediately.
- Damages to the electronics, the monitor or the lens caused by external influences such as impacts, falls or others are not covered by the warranty and must be paid for.
- Do not drop or bump the camera and always handle it carefully. Otherwise, the camera can be damaged.

3. INTRODUCTION

The Wildlife Camera is a wildlife and surveillance camera with 3 infrared sensor. The sensor can detect sudden changes to the ambient temperature within an evaluation area. The signals of the highly sensitive infrared sensor (PIR, passive infrared sensor) switch on the camera, activating picture or video mode.

Features Of Wildlife Camera

- CMOS sensor.
- 16 Megapixels photo and 1080P HD video.
- 6.1 cm (2.4") color TFT LCD; 480 x 234 pixels.
- 26 pcs IRLEDs.
- Full automatic IR filter, color photo and video in daytime and black photo and video in night time.
- Trigger speed: approx. 0.4 second; Pre boot 0.2 second
- Setup Serial No. to record the position.
- Time, date, temperature, phase and Serial No. will be stamped on the photo.
- Password protection.
- Power indicating.
- Built-in test function about environmental temperature.
- Built-in microphone and speaker.
- Mini USB 2.0 interface.
- Waterproof standard IP66.
- Working temperature: -20°C to 60°C (-4°F to 140°F).
- Extremely low power consumption in standby operation providing extremely long operating time, lasts 6 months with 8 pcs batteries when taking 50 pcs photos every day.

Areas Of Application

- Camera trap for hunting
- Animal or incident observation.
- Motion triggered security camera for domestic, office or public use.
- Any internal and external surveillance, where evidence of an infringement has to be provided.

4. STRUCTURE

Understanding the camera structure helps to use this product more skillfully.

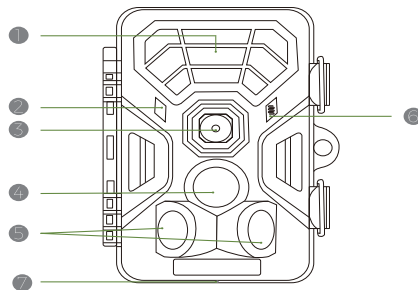

- LED infrared light
- Motion indicator blue and red LED
- Lens
- Central sensor zone
- Side sensor zones
- Light sensor
- Microphone

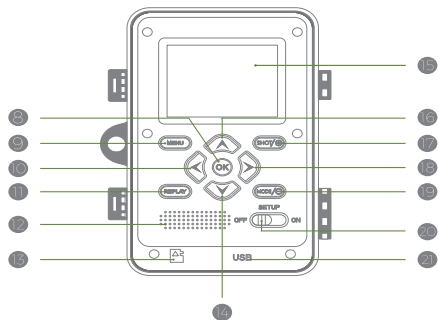

- 8. OK button
- 9. Menu button
- 10. Left button
- 11. Replay button
- 12. Speaker
- 13. Memory card slot
- 14. Down button
- 15. Monitor
- 16. Up button
- 17. Shot/zoom in button
- 18. Right button
- 19. Mode/zoom out button
- 20. Mode switch (OFF/SETUP/ON)
- 21. Mini USB connection

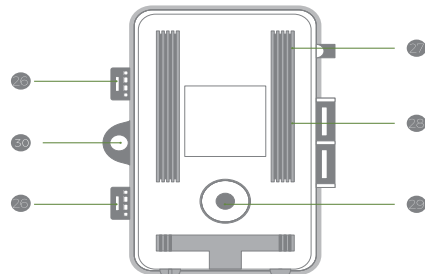
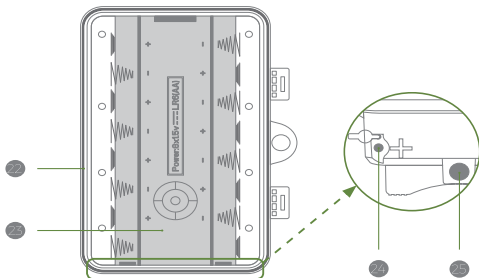

- 22. Seal ring
- 23. Battery compartment
- 24. DC connection 6V/2A
- 25. 1/4" Tripod thread
- 26. Locking brackets
- 27. Hole for wire lock
- 28. Slot for mounting belt
- 29. 1/4 tripod thread
- 30. Lock hole

- ⚠ 1. The monitor is only switched on in the Test mode for changing menu settings or viewing existing photos and videos.
2. TF memory card must have been inserted into the memory card slot to save photos and videos.
3. Using the mini USB connection (USB 2.0), the camera can be connected to a computer to download photos and videos.
4. Using the mode switch, the three operating modes OFF, SETUP and ON can be selected.

5. PREPARING THE CAMERA

Note :

1. TF memory cards up to a capacity of 32 GB are supported.
2. Instead of type LR6 (AA) batteries with the same specification (with 2000 mAh or higher) may be used. We recommend NiMh batteries with low self discharge (not supplied).



1. The camera must be inserted with 8 pcs AA batteries (AALR 6 batteries recommended). Do not use new and old batteries together. (DC interface need 6V/2A adaptor with 3.5 mm (outer diameter) s*1.3 mm (inner D) plug head.
2. Insert CLASS6 or higher class TF card (CLASS10 recommend). Prior to inserting memory card, ensure that the lateral write protection on the memory card has not been locked.
3. Switch on the camera. 3 switches: power off (OFF), setup menu/test mode (SETUP) and live mode (ON).
4. New memory card is recommended to be formatted when using (as described below).
5. Please note that the camera will power off when power is very low.



How to Assemble with Strap?

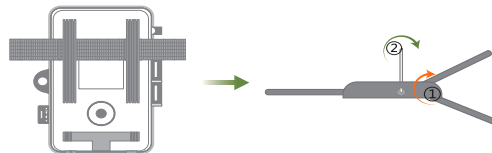

6. USING THE CAMERA AND SETUP MENU

6.1. Using The Camera

1. Mode Switch

The Mode switch is located at the bottom edge on the left inside. three operating modes can be selected:



Power off (OFF)



Setup system / test mode (SETUP)



Live mode (ON)

2. Operating Buttons

Functions of operating buttons in standby mode:

Below, the operating buttons are described in the standby mode with non-activated menu.

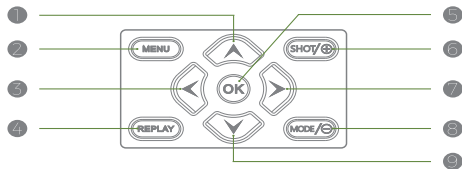

- 1/3/5/7/9. No function (in standby mode).
- 2. Open the Setting menu by using the MENU button.
- 4. Press this button to start the replay mode.
- 6. Press the button to take a photo, or start to record a video and end recording by pressing the button again.
- 8. Switch Camera/ Video modes.

Functions of operating buttons in REPLAY mode:

Below, the operating buttons are described in the reply mode with non-activated menu.

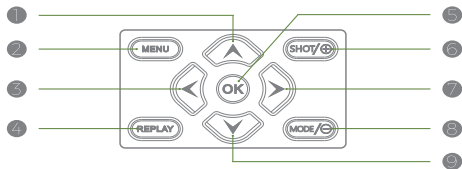

- 1. View existing photo or videos backwards. Drag upwards to view photos after magnifying.
- 2. Enter "Delete" page, or return.
- 3. Drag left to view photos after magnifying.
- 4. Press the button to return to recording mode.
- 5. Start or pause the replay of videos.
- 6. Zoom in the photos and increase the video volume.
- 7. Drag right to view photos after magnifying.
- 8. Zoom out the photos and decrease the video volume.
- 9. View existing photos or video forwards. Drag downwards to view photos after magnifying.

Functions of operating buttons in menu:

Below, the operating buttons are described in the MENU mode with activated menu.(Recording and Replay mode).

4 / 6 / 8. No function (in MENU mode).

- 1. Move up one menu point or increase value by 1.
- 2. Close the Main menu or any sub menu by pressing the MENU button.
- 3. Move backward to the data setting.
- 5. Open selected options or accept selected settings.
- 7. Move forward to the data setting.
- 9. Move down one menu point or decrease value by 1.

⚠ Confirm each change to a setting by pressing OK. If the change is not confirmed by pressing the OK button, the new settings will loss when leaving the menu.

6.2. Setup Menu

- 1. Mode: Camera, Video, Camera + Video

Select whether photos or videos should be taken when motion is detected. When in the "Camera + Video" mode, the camera first takes a set number of photos prior to recording a video.

- 2. Photo size

16M(5312 x 2988); 12M(4000 x 3000); 8M(3648 x 2048); 5M(2944 x 1656); 3M(2304 x 1296); 1M(1280 x 720).

Select the desired resolution for photos.

A higher resolution produces a somewhat better photo quality but results in larger files requiring more space on the memory card.

Taking 16GB memory card for example:

Photo Pixels	Resolution	Size (Mb)	Photo Quantity
16M	5312x2988	2	7400
12M	4000 x 3000	1.56	9487
8M	3648 x 2048	1.22	12131
5M	2944 x 1656	0.95	15579
3M	2304 x 1296	0.7	21143
1M	1280 x 720	0.35	42286

3. Video Size

1080P (1920 x1080P@30 fps), 720P (1280 x720P@30FPS), WVGA (848 x480@30fps), VGA (640 x480p@30 fps) Select the required video resolution.

A higher resolution produces higher quality videos but results in larger files requiring more space on the memory card. Videos are recorded in AVI format which can be played back on most video devices.

Taking 16GB memory card for example:

Video Resolution	Video Length: 10 seconds		Total recording time (Minute)	Frame number (FPS)
	Video size (MB)	Video quantity		
1920x1080	21	705	118	30
1280x720	20.5	722	120	30
848x480	13.9	1065	177	30
640x480	11.85	1249	208	30

4. Picture NO: 1P, 2P, 3P

Select the number of photos to be taken in succession when the camera is triggered the Photo mode. Please also observe the parameter interval!

Note:

- 1M, 3M, 5M can choose 1 photo, 2 photos, 3 photos;
- 8M can choose 1 photo, 2 photos, but 3 photos not available;
- 12M, 16M can choose 1 photo, but 2 photos, 3 photos not available.

5. Video Length

⚠ Default 10 seconds, optional 10s-59s, 1M,2M, 3M.

Specify the duration of a video recording when the camera is triggered automatically. The recording period for videos is not limited in the Test mode.

1. In the Test mode (SETUP) in daytime and at night.

- > When recording manually, the camera will stop automatically after 29 minutes' recording;
- > When recording manually, the camera will stop when one video clip size gets to 4 GB.
- > When recording manually, the camera will stop when the memory card is full or ultralow power.

2. In live mode (ON) at night, the camera will work automatically as per the video length setting. For low power, it will stop recording in advance.

3. Please set the shorter video length to guarantee a long-time usage of batteries.

6. Interval

⚠ Defaulted 30sec, optional from 5 seconds-60 minutes.

Select the shortest period for the camera to wait before it reacts to the successive triggering of the main sensor after an animal has first been detected. The camera does not record any photos or videos during the selected interval. This prevents the memory card from being filled with unnecessary shots.

1. The interval time is short, the camera shooting frequency would be high, and there would be high consumption of the power. It would affect the usage days of the batteries.

2. On the opposite, if the interval time is long, it would be a lower consumption of power to guarantee a long-time usage.

7. Time Lapse: Off / On

When "On" has been selected, the camera automatically takes photos or videos in the selected time interval, irrespective of whether or not the PIR sensor has detected a motion or not. This is useful for observing cold blooded animals e.g. snakes or plants opening up, etc.

As soon as the "On" setting has been confirmed by pressing the OK button, you can enter the interval time after which photos and videos are to be taken.

8. Time Stamp On / Off

Select "ON" to print the date, time, temperature and moon phase on each photo or video. Otherwise, select "Off".

9. Time Switch OFF / On

Set timer to "On" if camera should only be active within a certain time. Once "On" has been confirmed with the OK button, the start and end time can be set.

If the start time is, for instance set to 18:35 and the end time to 8:25, the camera will be operational from 6:35 pm of the current day until 8:25 am of the following day. The camera will not be triggered and will not take any photos or videos outside of this period.

10. Password Set Off / On

After selecting "On", enter a four-digit password to protect your camera against unauthorized access.

This password must enter each time when the camera is switched on in the Test mode before the camera can be used.

Note:

If you forget your password, please unlock the camera with password "OPEN".

11. Serial No. Set

It can only be used for photos not for videos.

You can use a combination of 4 digits to documents the location on the photos. When using several cameras, this makes it easier to identify the location when viewing photos.

12. Side PIR: On / Off

The two side PIR sensor zones provide a wide detection angle and detect more potential triggers.

Sometimes you only wish to observe a certain point.

Too many irrelevant triggers from the side sensor zones outside of this point continuously switch the camera on and off, considerably affecting battery life. In some situations it may be difficult to remove interfering branches or avoid sun light. In these situations you can switch off the side sensor zones.

13. PIR sensitivity: high / medium /low / auto

14. Language

Select the desired menu language.

The following languages are available: English, German, French, Spanish, Chinese, etc.

15. Format: No/Yes

Press OK button and select "YES", and then delete all files directly by pressing OK button again. We recommend formatting the memory card if it has already been used in other devices or if it is a new card.

Caution:

Ensure that files still required have been backed up prior to formatting!

16. Set Clock: Set date and time

Press OK button to set date and time. Using the ► and ◀ buttons to skip between values and change selected values by pressing the ▲ and ▼ buttons. Confirm your setting by pressing the OK button.

17. Default set: No/Yes

Press "Yes" to reset the camera setting to the default values and confirm the selection by pressing the OK button.

18. Auto Power Off

3 min / 5 min / 10 min /off ,default 5Min.

With this function, you can determine whether the camera should be automatically switched off when not used for some time in the Test mode. Set the time after then the camera should be switched off in the Test mode or deactivate automatic switch off by selecting "ON" / "OFF"

19. Beep sound: On / Off

20. Volume Rec: On/Off

21. Volume Play: Low/ Normal/ High

22. System: There are two available options.

22.1. FW Version

Shows the firmware version installed on the camera. In replay mode, the option delete is available in the menu.

22.2. FW Update

If the memory card contains new firmware, it can be installed by confirming the option by pressing the OK button.

During the update, the respective status is shown on the display.

7. ENTERING LIVE MODE

7.1. Adjusting And Installing The Camera

The Test mode (SETUP) is advantageous for determining the best possible detection angle and range of the movement sensor. For this purpose, attach the camera at approx. 1-2m height to a tree and align the camera with a desired direction.

- Tie on one meter height, being parallel to the ground.
- Tie on two meter height, tilting down to 5 degrees.

Move slowly from one side of the observed area to the other. Move parallel to the camera. Try out different angles and distances.

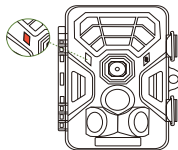

- The blue LED on the front of the camera indicate that you are detected by a side sensor zone.
- The red LED on the front of the camera indicates that you were detected by a central sensor zone.

In this way you can determine the best position for aligning the camera.

The red LED only flashes in the Test mode (SETUP) as soon as the PIR sensor has detected movement.

The red LED will flash for 5 times when you just switch to Live mode (ON), and then the camera works automatically and enters the Standby mode.

To prevent incorrect signals and unnecessary photos, we recommend not using the camera at sunny points and check that no branches are in the active area of the sensor.

Optimum alignment is in North or South direction. The detection range of the sensors is approx.120°, the detection range of the lens is approx.73°.

Also check that the camera is set to the correct height in line with the point to be observed. If necessary, point the camera down for optimum alignment.

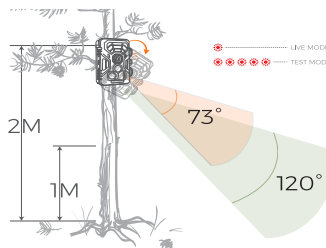

Note:

Please do the horizontal movement before the PIR, vertical movement could not detect correctly.

Please quicken your steps when you do the test in a long distance before PIR detection area.

The PIR detection distance would be shorter if the environment temperature reaches or above 30°.

The machine would automatically turn off without any operation within 5 minutes, please switch to "OFF" button and then switch to "SETUP" button again to restart the system.

7.2. Setting Up The Live Mode

The standard application of the Wildlife Camera is the Live mode. In this mode, photos are either triggered by movement sensors or at intervals according to the respective setting.

To set up the Live mode, switch mode switch to ON position. The red LED will flash for 5 times when you just switch to Live mode (ON), and then the camera works automatically and enters the Standby mode.

As soon as wild animals or other objects directly enter the detection area of the sensor zone, the camera will start to record photos and videos.

Note:

In the daytime. IR LEDs will not light up. The photos and videos are in color.

At night. IR LEDs will flash, and the photos and videos are in black and white.

The interval is 30seconds defaulted. The optional is 5s-60 min.

Please set up recording mode and related parameters before entering Live mode.

8. CONNECTION TO COMPUTER

Please shift Mode to "OFF", and connect the camera to computer with USB cable, the camera LCD will show "MSDC" prompt. This indicates connecting successfully. And then read or copy the data in SD card to the computer.

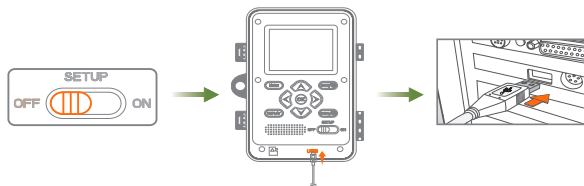

System requirements

Windows	Macintosh
Pentium III or higher	PowerPC G3/G4/G5
Windows XP/Vista/7/8	OS 10.3.9 or newer system
512 MB RAM	512 MB RAM
1GB available hard disk space	1GB available hard disk space
Screen resolution 1024 x 768 or higher	Screen resolution 1024 x 768 or higher
Available USB connection	Available USB connection

1. Connect the camera to your computer using the USB cable.
2. The camera switches on automatically in the USB mode, irrespective of the selection on the mode switch.
3. The camera installs itself on the computer as an additional drive under the name "Removable storage device".
4. Double click on the device to detect the folder "DCIM"
5. The photos and videos are in the sub folders of the "DCIM" folder.
6. You can copy or move photos and video files on the computer.

Alternatively, you can insert the memory card in a card reader on the computer.

Note:

Mac computers show an "Unknown" drive on the desktop. When clicking on this drive, the program "iPhoto" is automatically started.

9. TECHNICAL SPECIFICATION

Element	Macintosh
Photo resolution	16M; 12M; 8M; 5M; 3M; 1M
Screen	6.1 cm (2.4") color TFTLCD; 480 x234 pixels
Recording medium	Supports TF memory cards up to 32 GB (optional)
Video resolutions	1080P; 1920 x1080 (30fps); 720P; 1280 x720 (30fps); WVGA: 848 x480(30fps); VGA: 640 x480 (30fps)
Lens	f=3.1mm, F/NO=2.6; FOV=73°; Auto IR filter
The distance of night version	20m
Triggering distance	Up to 20 meters
Triggering time	approx. 0.4 second; Pre boot 0.2 second
Interval	5 seconds to 60 minutes
IR flash	26pcs 850/940nm (option) IR LEDs for night shots (range 20m)(65ft)
Detection angle of sensor	Central sensor zone: 50°; Side sensor zone: each 30°; Total sensor angle zone: 120°
Spray water protected	Yes (IP66)
Storage formats	Photo: JPEG; Video: AVI, MJPG
Connections	Mini USB 2.0
Standby time	Approx.6 months (with 8 batteries)
Dimensions	approx. 135 (H) x 98 (B) x76 (T) mm (5.3 x 3.8 x 2.9 inch)
Weight	287g(10.1oz)

Power supply	8 x batteries type LR6 (AA); 8 x NiMH batteries type LR6 (AA) with low discharge. External 6V power supply, at least 2.0a (not supplied)
--------------	--

The camera can not turn off	Once such malfunction occurs, remove all the batteries to reset the camera.
Forget the password	Please enter the words "OPEN", in case that you forget the password to start the machine.

10. SIMPLE TROUBLE SHOOTING

The camera will not turn on	<ol style="list-style-type: none"> 1. Please check whether the batteries are installed in proper way. 2. Check if the battery capacity is low or exhausted. If so, please replace by new batteries.
The camera turns off automatically	<ol style="list-style-type: none"> 1. Please check whether the battery capacity is low or exhausted. If so, try to change new batteries for outdoor using or connect AC adapter for indoor using. 2. Please check if TF card is full. If so, transfer images and videos to your computer or delete some files in the Replay Mode.
It shows "TF card Error"	<ol style="list-style-type: none"> 1. Please ensure that TF card is with class 10 standard or higher level. 2. Please use the camera to format TF card at the first time.
Videos are choopy or jumpy when played on a computer	<ol style="list-style-type: none"> 1. Ensure that the computer system requirements are met. 2. Ensure AVI format Video clip can be played on your computer.
The image is not clear	1. Please ensure that you have removed the protective films on IR LEDs and lens before using.
The camera does not take images or record videos	1. If the memory of TF card is full, transfer images or videos to your computer or delete some files in the Replay Mode.

11. SYSTEM INFORMATION, MAINTENANCE AND DISPOSAL

Trademark Information

Microsoft® and Windows® are trademarks of Microsoft Corporation registered in the US.

Pentium® is a registered trademark of Intel Corporation.

Macintosh is a trademark of Apple Computer Inc.

SD™ is a trademark.

Other names and products can be trademarks or registered trademarks of the respective owners.

11.1. Care

Do not use any corrosive cleaners, such as methylated spirits, thinners, etc. to clean the camera housing and supplied accessory. When required, clean system components with a soft dry cloth.

11.2. Storage

Always remove the battery from the housing if the camera is not being used for some time and store the battery separately. On a day to day basis and over longer periods the batteries can be kept at a dry location out of the reach of children.

11.3. Disposal

For disposal, separate packaging into different types and dispose of in line with environmental regulations in supplied collection containers. Batteries and storage batteries may not be disposed of in domestic waste. Consumers are obliged by law to return used batteries to communal collection points or dealers selling batteries.

Storage batteries and batteries do therefore contain the adjacent symbol.

Correct disposal of product:

The adjacent symbol indicates that electrical and electric equipment may not be disposed of in domestic waste in the EU. Please use the returns and collection points of your local council or contact your dealer you purchased the product from. This prevents potentially harmful effects on the environment and health as a result of incorrect disposal. For further information, contact the respective department of your local council.

off and on, the user is encouraged to try to correct the interference by one or more of the following measures:

- Reorient or relocate the receiving antenna.
- Increase the separation between the equipment and receiver.
- Connect the equipment into an outlet on a circuit different from that to which the receiver is connected.
- Consult the dealer or an experienced radio/TV technician for help.

12. FCC STATEMENT

Operation is subject to the following three conditions:

- (1) This device may not cause harmful interference.
- (2) This device must accept any interference received, including interference that may cause undesired operation.
- (3) This device has been evaluated to meet general RF exposure requirement. The device can be used in portable exposure condition without restriction.

Note:

This equipment has been tested and found to comply with the limits for a Class B digital device, pursuant to part 15 of the FCC Rules. These limits are designed to provide reasonable protection against harmful interference in a residential installation. This equipment generates, uses and can radiate radio frequency energy and, if not installed and used in accordance with the instructions, may cause harmful interference to radio communications. However, there is no guarantee that interference will not occur in a particular installation. If this equipment does cause harmful interference to radio or television reception, which can be determined by turning the equipment