

Tovendor Trail Camera

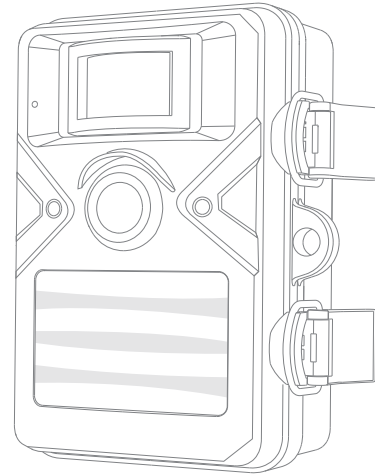

Instruction Manual

Check out warranty policy at www.tovendor.com/warranty for more details. Your satisfaction is the objective which we serve. Please feel free to contact us if any questions.

Shenzhen Aosom E-commerce Co., Ltd
Email: service@tovendor.com
Site: www.tovendor.com

Ver 1.1

Dear customer, congratulations on purchasing a quality product.

You have purchased a modern Wildlife Camera with excellent technical features and respective accessory that is particularly easy to operate. Please study all notices carefully and diligently. Please study this information in detail, especially the safety instructions.

The camera complies with CE, FCC and RoHS standard, and users have security assurance.

Contents

| | |
|--------------------------------------------------------|----|
| 1. PACKING LIST | 01 |
| 2. HAZARD, SAFETY AND WRNING NOTICES | 01 |
| 3. INSTRDUCTION | 03 |
| 4. STRUCTURE | 04 |
| 5. PREPARING THE CAMERA | 06 |
| 6. USING THE CAMERA AND SETUP MENU | 08 |
| 6.1 Using the camera | 08 |
| 6.2 Setup menu | 10 |
| 7. ENTERING AUTOMATIC MONITORING..... | 15 |
| 7.1 Adjusting and installing the camera..... | 15 |
| 7.2 Setting up the live mode..... | 16 |
| 8. CONNECTION TO COMPUTER..... | 17 |
| 9. TECHINCAL SPECIFICATION | 18 |
| 10. SIMPLE TROUBLESHOOTING | 19 |
| 11. SYSTEM INFORMATION, MAINTENANCE AND DISPOSAL | 20 |
| 11.1 Care | 20 |
| 11.2 Storage | 20 |
| 11.3 Disposal..... | 21 |
| 12. FCC STATEMENT | 21 |

1. PACKING LIST

Please carefully unpack camera and check that below accessories are contained in the box.

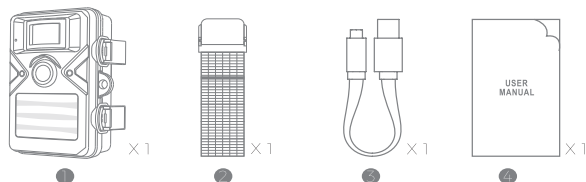

1. Wildlife Camera
2. Mounting Belt
3. USB cable
4. Instruction Manual

2. HAZARD, SAFETY AND WARNING NOTICES

Incorrect use of the camera and accessories can be dangerous for you and others and can damage or destroy the camera. We therefore ask you to read and strictly observe the following Hazard, safety and warning notices.

Intended Use

1. The camera, accessory and packaging are not toys for children. These should therefore always be kept away from children in case of danger of electrocution, poisoning and suffocation.
2. The camera and accessory may not be used by children and persons with limited abilities. The camera may not be operated by persons physically and mentally able to operate it safely.

Electrical Hazard

1. Switch off the camera and remove the batteries if a foreign body or liquid has entered the camera. Let all parts dry thoroughly. Otherwise, there exists danger of fire or electrocution.
2. Switch off the camera and remove the batteries if the camera has been dropped or the housing is damaged. Otherwise, there exists danger of fire and electrocution.
3. The camera may not be dismantled, modified or repaired. Otherwise, there exists danger of fire and electrocution.
4. Only a power adaptor (not supplied) with the mains voltage specified on the rating plate (6V) can be used. Otherwise, there exists danger of fire or electrocution. Disconnect the power by pulling the power adapter out of the socket.
5. A plugged in power adaptor (not supplied) can continue to use power, but protect it from a hazard source.
6. The power supply may not be used during thunderstorms. Otherwise, there exists danger of electrocution.

Damage From Heat-Fire Hazard

1. Do not leave the camera in places that are susceptible to considerable increases in temperature (e.g. a vehicle). The housing and internal parts may be damaged, which in turn could cause a fire.
2. Do not wrap up camera or place it on textile. This could produce a build-up of heat in the camera that can cause deformation of the housing and may represent a fire hazard.

Injuries And Material Damage

1. Only place the camera on sturdy surfaces. The camera could otherwise fall or topple over, causing damage or injury.
2. Do not operate the camera while running or driving. You could fall or cause a traffic accident.
3. Only a mains adaptor (not supplied), whose input voltage specified on the rating plate(6V) can be used for the camera. We do not accept any liability for damage caused by the incorrect use mains adaptor.
4. The 230V socket used for the mains adaptor (not supplied) must not be covered and accessible at all time so that the mains adaptor can be quickly disconnected from the mains, when required.
5. Ensure adequate ventilation and do not cover the mains adaptor (not supplied) to avoid overheating.

6. Do not place any ignition sources, such as lit candles onto or close to the device. Do not subject the LCD monitor to impact or pressure. This could damage the glass of the monitor or the liquid could leak from the inside. In case of contact with eyes or skin, rinse immediately with clear water. In case of contact with eyes, contact a doctor immediately.
7. Damages to the electronics, the monitor or the lens caused by external influences such as impacts, falls or others are not covered by the warranty and must be paid for.
8. Do not drop or bump the camera and always handle it carefully. Otherwise, the camera can be damaged.

3. INTRODUCTION

The Wildlife Camera is a wildlife and surveillance camera with an infrared sensor. The sensor can detect sudden changes to the ambient temperature within an evaluation area. The signals of the highly sensitive infrared sensor (PIR, passive infrared sensor) switch on the camera, activating picture of video mode.

Features Of Wildlife Camera

1. CMOS sensor.
2. 16 Megapixels photo and 1080P HD video.
3. 6.1 cm (2.4") color TFT LCD; 480 x 234 pixels.
4. 40 pcs IRLEDs.
5. Full automatic IR filter, color photo and video in day and black night.
6. Trigger speed: Approx. 0.3 second.
7. Setup Serial No. to record the position.
8. Time, date, temperature, phase and Serial No. will be stamped on the photo.
9. Password protection.
10. Power indicating.
11. Built-in test function about environmental temperature.
12. Built-in microphone and speaker.
13. Mini USB 2.0 interface.
14. Waterproof standard IP66.
15. Working temperature: -20°C to 60°C.
16. Extremely low power consumption in standby operation providing extremely long operating time, lasts 6 months with 8 pcs batteries when taking 50 pcs photos every day.

Areas Of Application

1. Camera trap for hunting
2. Animal or incident observation.
3. Motion triggered security camera for domestic, office or public use.
4. Any internal and external surveillance, where evidence of an infringement has to be provided.

4. STRUCTURE

Understanding the camera structure helps to use this product more skillfully.

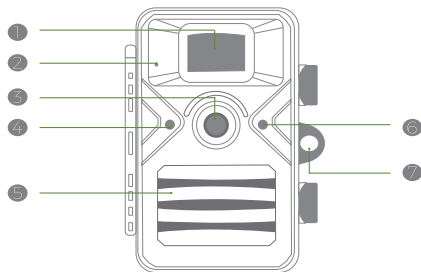

1. Sensor zone
2. Microphone
3. Lens
4. Light sensor
5. LED infrared light
6. Motion indicator red LED
7. Lock hole

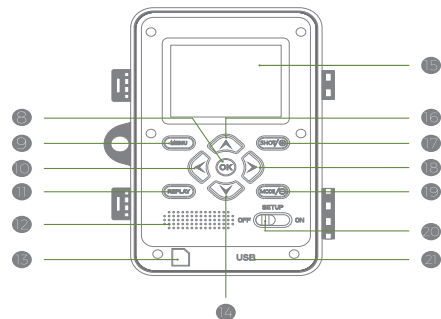

- | | |
|----------------------|--------------------------------|
| 8. OK button | 15. Monitor |
| 9. Menu button | 16. Up button |
| 10. Left button | 17. Shot/zoom in button |
| 11. Replay button | 18. Right button |
| 12. Speaker | 19. Mode/zoom out button |
| 13. Memory card slot | 20. Mode switch (OFF/SETUP/ON) |
| 14. Down button | 21. Mini USB connection |

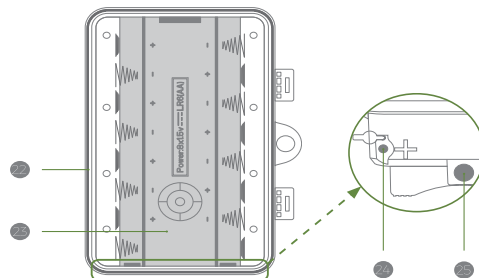

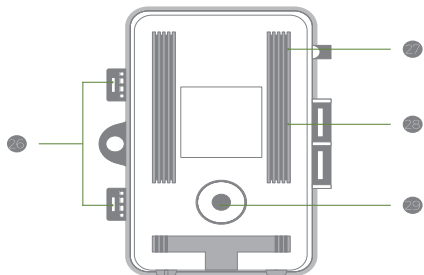

- | | |
|-------------------------|----------------------------|
| 22. Seal ring | 26. Locking brackets |
| 23. Battery compartment | 27. Hole for wire lock |
| 24. DC connection 6V/2A | 28. Slot for mounting belt |
| 25. 1/4" Tripod thread | 29. 1/4 tripod thread |

- ⚠ 1. The monitor is only switched on in the Test mode for changing menu settings or viewing existing photos and videos.
2. ASD or SDHC memory card must have been inserted into the memory card slot to save photos and videos.
3. Using the mini USB connection (USB 2.0), the camera can be connected to a computer to download photos and videos.
4. Using the mode switch, the three operating modes OFF, SETUP and ON can be selected.

5. PREPARING THE CAMERA

Note :

- SD/ SDHC memory cards up to a capacity of 32 GB are supported.
- Instead of type LR6 (AA) batteries with the same specification (with 2000 mAh or higher) may be used. We recommend NiMH batteries with low self discharge (not supplied).



- The camera must be inserted with 8 pcs AA batteries (AALR6 batteries recommended). Do not use new and old batteries together. (DC interface need 6V/2A adaptor with 3.5 mm (outer diameter) s*1.3 mm (inner D) plug head.
- Insert CLASS10 SD card. Prior to inserting memory card, ensure that the lateral write protection on the memory card has not been locked.
- Switch on the camera. 3 switches: power off (OFF), setup menu/test mode (SETUP) and live mode (ON).
- New memory card is recommended to be formatted when using (as described below).
- Please note that the camera will power off when power is very low.

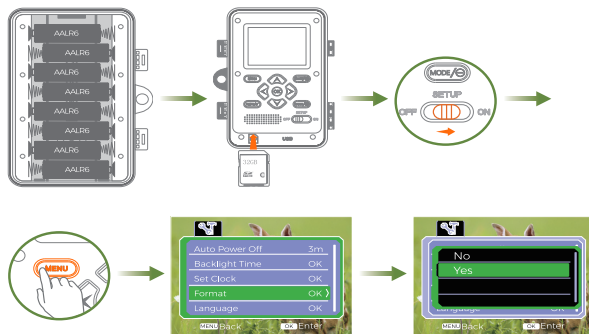

Operation (See Figures Below)

Open the locking brackets and the protective cover of the battery compartment—insert batteries—insert memory card—switch to SETUP—enter system

menu by pressing MENU button—choose to format memory card—choose to reset to factory (this step can be skipped)—choose to setup system time.

Open the battery cover ▶ Insert 8pcs batteries. Battery model: AALR6 ▶ Ensure that the lateral write protection on the memory card has not been activated ▶ Insert CLASS10 or above SD/ SDHC memory card in the memory card slot before switching on the camera and select SETUP mode to adjust settings ▶

Assembly With Strap

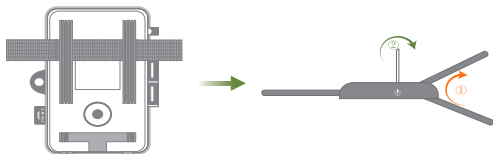

6. USING THE CAMERA AND SETUP MENU

6.1. Using The Camera

1. Mode Switch

Shift the switches to choose work mode:



Power off (OFF)



Setup system / test mode (SETUP)



Live mode (ON)

Note:

Off: Power Down

Setup: Take/Replay Pictures & Videos / Choose Working Modes

ON: Living Mode. The screen becomes dark to save power after 5s.

You have to switch to "Setup" to wake the screen

2. Operating Buttons

Functions of operating buttons in recording mode:

Below, the operating buttons are described in the recording mode with non-activated menu.

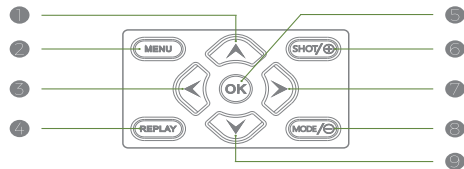

1/3/5/7/9. No function (in recording mode).

2. Open the Setting menu using the MENU button.

4. Press this button to start the replay mode.

6. Press the button to take a photo, or start to record a video and end recording by pressing the button again.

8. Switch Camera/ Video modes.

Functions of operating buttons in recording mode:

Below, the operating buttons are described in the recording mode with non-activated menu.

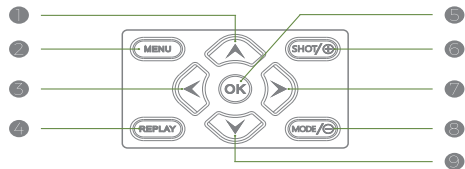

1. View existing photo or videos backwards. Drag upwards to view photos after magnifying.

2. Enter "Delete" page, or return.

3. Drag left to view photos after magnifying.

4. Press the button to return to recording mode.

5. Start or end the replay of videos.

6. Zoom in the photos and increase the video play volume.

7. Drag right to view photos after magnifying.

8. Zoom out the photos and decrease the video play volume.

9. View existing photos or video forwards. Drag downwards to view photos after magnifying.

Functions of operating buttons in menu:

Below, the operating buttons are described in the MENU mode with activated menu.(Recording and Replay mode).

4 / 6 / 8. No function (in MENU mode).

1. Move up one menu point or increase value by 1.
2. Close the Main menu or any sub menu by pressing the MENU button.
3. Move backward to the data setting.
5. Open selected options or accept selected settings.
7. Move forward to the data setting.
9. Move down one menu point or decrease value by 1.

⚠ Confirm each change to a setting by pressing OK. If the change is not confirmed by pressing the OK button, the new settings are lost when leaving the menu.

6.2. Setup Menu

1. Mode

Camera, Video, Camera+Video, Timer still, Timer video. Camera is in default. Select whether photos or videos should be taken when motion is detected. When in the "Camera+Video" mode, the camera first takes a set number of photos prior to recording a video.

Note:

In these two modes (Timer Still and Timer Video), PIR will stop working, and the camera will enter the mode of Periodic Shot.

2. Photo size

16M (5312 x 2988), 12M (4000 x 3000), 8M (3840 x 2160), 5M (3072 x 1728), 2M (1920 x 1080), 0.5M (1024 x 576), 5M in default.

Select the desired resolution for photos. We recommend the resolution 5M.

A higher resolution produces a somewhat better photo quality but results in larger files requiring more space on the memory card. 16M, 12M and 8M resolutions are generated by interpolation which can also affect quality.

Taking 16GB memory card for example:

| Photo Pixels | Resolution | Size (Mb) | Photo Quantity |
|--------------|------------|-----------|----------------|
| 16M | 5312x2988 | 3.7 | 4059 |
| 12M | 4000x3000 | 3.32 | 5460 |
| 8M | 3840x2160 | 2.94 | 5570 |
| 5M | 3072x1728 | 2.22 | 7380 |
| 2M | 1920x1080 | 1.44 | 11370 |
| 0.5M | 1024x576 | 0.62 | 26420 |

3. Video Size

1080P (1920 x1080P@30 fps), 720P (1280 x720P@30FPS), WVGA (848 x480@30fps), VGA (640 x480p@30 fps) Select the required video resolution.

A higher resolution produces higher quality videos but results in larger files requiring more space on the memory card. Videos are recorded in AVI format which can be played back on most video devices.

Taking 16GB memory card for example:

| Video Resolution | Video Length: 10 seconds | | Total recording time (Minute) | Frame number (FPS) |
|------------------|--------------------------|----------------|-------------------------------|--------------------|
| | Video size (MB) | Video quantity | | |
| 1920x1080 | 46.2 | 350 | 58 | 30 |
| 1280x720 | 34.4 | 470 | 78 | 30 |
| 848x480 | 17.8 | 920 | 153 | 30 |
| 640x480 | 13.4 | 1220 | 203 | 30 |

4. Picture NO: 1P, 2P, 3P

Select the number of photos to be taken in succession when the camera is triggered in the Photo mode. Please also observe the parameter interval!

5. Video Length

⚠ Default 10 seconds, optional 10s-59s, 1M,2M, 3M.

Specify the duration of a video recording when the camera is triggered automatically. The recording period for videos is not limited in the Test mode.

1. In the Test mode (SETUP) in daytime and at night.

- > When recording manually, the camera will stop automatically after 29 minutes' recording.
- > When recording manually, the camera will stop when one video clip size gets to 4 GB.
- > When recording manually, the camera will stop when the memory card is full or ultralow power.

2. In live mode (ON) at night, the camera will work automatically as per the video length setting. For low power, it will stop recording in advance.

3. Please set the shorter video length to guarantee a long-time usage of batteries.

6. Interval

 Defaulted 30 seconds, optional from 5 seconds-60 minutes.

Select the shortest period for the camera to wait before it reacts to the successive triggering of the main sensor after an animal has first been detected. The camera does not record any photos or videos during the selected interval. This prevents the memory card from being filled with unnecessary shots.

1. The interval time is short, the camera shooting frequency would be high, and there would be high consumption of the power. It would affect the usage days of the batteries.

2. On the opposite, if the interval time is long, it would be a lower consumption of power to guarantee a long-time usage.

Periodic Interval:

optional from 5 seconds- 24 hours.

This option is used to set up the fixed time. In Mode of MENU, there are two modes of **Timer Still** (taking photos at a fixed time) and **Timer Video** (recording videos at a fixed time). So, this option is used together with these two modes.

Note:

In these two modes (Timer Still and Timer Video), PIR will stop working.

7. Shutter

- 1/15, high sensitivity at night, the blur is obvious when shooting an animal moving very quickly.
- 1/20, middle sensitivity at night, the blur is less obvious when shooting an animal moving very quickly.

- 1/30, low sensitivity at night, the blur is not obvious when shooting an animal moving very quickly. 1/20 is in default. Please select the suitable Shutter speed as per your actual requirement.

8. Time Stamp On / Off

Select "ON" to print the date, time, temperature and moon phase on each photo or video. Otherwise, select "Off".

9. Time Switch OFF / On

Set timer to "On" if camera should only be active within a certain time. Once "On" has been confirmed with the OK button, the start and end time can be set.

If the start time is, for instance set to 18:35 and the end time to 8:25, the camera will be operational from 6:35 pm of the current day until 8:25 am of the following day. The camera will not be triggered and will not take any photos or videos outside of this period.

10. Password Set Off / On

After selecting "On", enter a four-digit password to protect your camera against unauthorized access.

This password must enter each time when the camera is switched on in the Test mode before the camera can be used.

Note:

If you forget your password, please unlock the camera with password "OPEN".

11. Serial No. Set Off/On

It can only be used for photos not for videos.

You can use a combination of 4 digits to documents the location on the photos. When using several cameras, this makes it easier to identify the location when viewing photos.

12. Flash light: Auto, High, Low.

Set the infrared LEDs brightness.

13. Volume Rec: On/Off

14. Volume Play: Low/ Normal/ High

15. Beep sound Off/On

16. Auto Power Off

3 min / 5 min / 10 min /off ,default 5Min.

With this function, you can determine whether the camera should be automatically switched off when not used for some time in the Test mode. Set the time after which the camera should be switched off in the Test mode or deactivate automatic switch off by selecting "OFF"/ "ON"

17. Backlight timer

3 Minute, optional 1 Min, 3Min, 5 Min, OFF.

The LCD monitor would automatically turn off after the setting time.

18. Set Clock: Set date and time

19. Format: No/Yes

Press OK button and select "YES", and then delete all files directly by pressing OK button again. We recommend formatting the memory card if it has already been used in other devices or if it is a new card.

Caution:

Ensure that files still required have been backed up prior to formatting!

20. Language

Select the desired menu language.

The following languages are available: English, German, French, Spanish, Italian, etc.

21. Default Set: NO/ Yes

Press OK button and select "YES", and then reset the camera settings to the default values by pressing OK button again.

Please note to set date and time again.

22. System: There are two available options.

● Fw Version

Shows the firmware version installed on the camera. In replay mode, the option delete is available in the menu.

● Fw Update

If the memory card contains new firmware, it can be installed by confirming the option by pressing the OK button.

During the update, the respective status is shown on the display.

7. ENTERING LIVE MODE

7.1. Adjusting And Installing The Camera

The Test mode (SETUP) is advantageous for determining the best possible detection angle and range of the movement sensor. For this purpose, attach the camera at approx. 1-2m height to a tree and align the camera with a desired direction.

For 1. meter height, normal to ground.

For 2. meters height, down to 5 degrees.

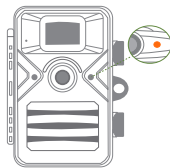

Move slowly from one side of the observed area to the other. Move parallel to the camera. Try out different angles and distances.

The red LED flashing indicated that you were detected by PIR sensor. In this way you can determine the best position for aligning the camera.

The red LED only flash in the Test mode (SETUP) as soon as the PIR sensor has detected movement.

The red LED will flash for 5 times when you just switch to Live mode (ON), and then the camera work automatically and enters the Standby mode.

To prevent incorrect signals and unnecessary photos, we recommend not using the camera at sunny points and check that no branches are in the active area of the sensor.

Optimum alignment is in North or South direction. The detection range of the sensors is approx.50°, the detection range of the lens is approx. 49°.

Also check that the camera is set to the correct height in line with the point to be observed. Where necessary, point the camera down for optimum alignment.

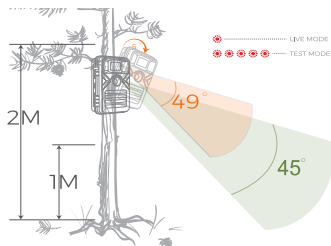

Note:

Please do the horizontal movement before the PIR, vertical movement could not detect correctly.

Please quicken your steps when you do the test in a long distance before PIR detection area.

The PIR detection distance would be shorter if the environment temperature reaches or above 30°.

The machine would automatically turn off without any operation within 3minutes, please switch to "OFF" button and then switch to "SETUP" button again to restart the system.

7.2. Setting Up The Live Mode

The standard application of the Wildlife Camera is the Live mode. In this mode, photos are either triggered by movement sensors or at intervals according to the respective setting.

To set up the Live mode, switch mode switch to ON position. The red LED will flash for 5 times when you just switch to Live mode (ON), and then the camera work automatically and enters the Standby mode.

As soon as wild animals or other objects directly enter the detection area of the sensor zone, the camera starts to record photos and videos.

Note:

In the daytime, IR LEDs will not light up. The photos and videos are in color.
At night, IR LEDs will give lights, and the photos and videos are in black and white.

The interval is 1 minute defaulted. The optional is 5s-60 MIN.

Please set up recording mode and related parameters before entering Live mode.

When Flash Light is set to "Auto", the camera will adjust the brightness of IR LEDs automatically in low power. When shooting at night, the brightness will decrease automatically, and the shooting effect will become a little poor. For ultralow power, shooting will stop at night.

8. CONNECTION TO COMPUTER

Please shift Mode to "OFF", and connect the camera to computer with USB cable, the camera LCD will show "MSDC" prompt. This indicates connecting successfully. And then read or copy the data in SD card to the computer.

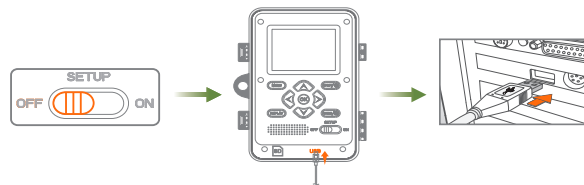

System requirements

| Windows | Macintosh |
|----------------------------------------|----------------------------------------|
| Pentium III or higher | PowerPC G3/G4/G5 |
| Windows XP/Vista/7/8 | OS 10.3.9 or newer system |
| 512 MB RAM | 512 MB RAM |
| 1GB available hard disk space | 1GB available hard disk space |
| Screen resolution 1024 x 768 or higher | Screen resolution 1024 x 768 or higher |
| Available USB connection | Available USB connection |

1. Connect the camera to your computer using the USB cable.
2. The camera switches on automatically in the USB mode, irrespective of the selection on the mode switch.
3. The camera installs itself on the computer as an additional drive under the name "Removable storage device".
4. Double click on the device to detect the folder "DCIM"
5. The photos and videos are in the sub folders of the "DCIM" folder.
6. You can copy or move photos and video files on the computer.

Alternatively, you can insert the memory card in a card reader on the computer.

Note:

Mac computers show an "Unknown" drive on the desktop. When clicking on this drive, the program "iPhoto" is automatically started.

9. TECHNICAL SPECIFICATION

| Element | Macintosh |
|-------------------------------|-----------------------------------------------------------------------------------------------------------------------|
| Image sensor | HD CMOS sensor |
| Photo resolution | 16 M (5312 x 2988), 12 MP: 4000 x 3000 8 MP: 3840 x 2160, 5MP: 3072 x 1728, 2MP: 1920 x 1080, 0.5MP: 1024 x 576 |
| Screen | 6.1cm (2.4") color TFTLCD; 480 x234 pixels |
| Recording medium | Supports SD/SDHC memory cards up to 32 GB (optional) |
| Video resolutions | 1080P: 1920 x1080 (30fps), 720P: 1280 x720 (30fps), WVGA: 848 x480 (30fps), VGA: 640 x480 (30fps) |
| Lens | F=7.45; F/NO=2.4; FOV=49°; Auto IR filter |
| The distance of night version | 20m |
| Triggering distance | Up to 20 meters |
| Triggering time | 0.3 second |
| Interval | 5 seconds to 60 minutes |
| IR flash | 40 pcs infrared LEDs |
| Detection angle of sensor | 45° |
| Spray water protected | Yes (IP66) |
| Storage formats | Photo: JPEG; Video: AVI, MJPG |
| Connections | Mini USB 2.0 |
| Standby time | Approx.6 months (with 8 batteries) |
| Dimensions | Approx. 135(H) x 101(B) x73 (T)mm |

| | |
|------------|------------------------------------------------------------------------------------------------------------------------------------------------|
| Dimensions | 8 x batteries type LR6 (AA); 8 x NiMH batteries type LR6 (AA) with low discharge; External 6V power supply, at least 2.0a (not supplied) |
|------------|------------------------------------------------------------------------------------------------------------------------------------------------|

10. SIMPLE TROUBLE SHOOTING

| | |
|------------------------------------------------------|-----------------------------------------------------------------------------------------------------------------------------------------------------------------------------------------------------------------------------------------------------------------------------------------------------------------------------------------------------------|
| The camera will not turn on | <ol style="list-style-type: none"> 1. Please check whether the batteries are installed in proper way. 2. Check if the battery capacity is low or exhausted. If so, please replace by new batteries. |
| The camera turns off automatically | <ol style="list-style-type: none"> 1. Please check whether the battery capacity is low or exhausted. If so, try to change new batteries for outdoor using or connect AC adapter for indoor using. 2. Please check if SD card is full. If so, transfer images and videos to your computer or delete some files in the Replay Mode. |
| It shows "SD card Error" | <ol style="list-style-type: none"> 1. Please ensure that SD card is with class 10 standard or higher level. 2. Please use the camera to format SD card at the first time. |
| Videos are choopy or jumpy when played on a computer | <ol style="list-style-type: none"> 1. Ensure that the computer system requirements are met. 2. Ensure AVI format Video clip can be played on your computer. |
| The image is not clear | 1. Please ensure that you have removed the protective films on IR LEDs and lens before using. |
| The camera does not take images or record videos | 1. If the memory of SD card is full, transfer images or videos to your computer or delete some files in the Replay Mode. |

| | |
|-----------------------------|-------------------------------------------------------------------------------------------|
| The camera can not turn off | Once such malfunction occurs, remove all the batteries to reset the camera. |
| Forget the password | Please enter the words "OPEN", in case that you forget the password to start the machine. |

11. SYSTEM INFORMATION, MAINTENANCE AND DISPOSAL

Trademark Information

Microsoft® and Windows® are trademarks of Microsoft Corporation registered in the US.

Pentium® is a registered trademark of Intel Corporation.

Macintosh is a trademark of Apple Computer Inc.

SD™ is a trademark.

Other names and products can be trademarks or registered trademarks of the respective owners.

11.1. Care

Do not use any corrosive cleaners, such as methylated spirits, thinners, etc. to clean the camera housing and supplied accessory. When required, the clean system components with a soft dry cloth.

11.2. Storage

Always remove the battery from the housing if the camera is not being used for some time and store the battery separately. On a day to day basis and over longer periods the batteries can be kept at a dry location out of the reach of children.

11.3. Disposal

For disposal, separate packaging into different types and dispose of in line with environmental regulations in supplied collection containers. Batteries and storage batteries may not be disposed of in domestic waste. Consumers are obliged by law to return used batteries to communal collection points or dealers selling batteries.

Storage batteries and batteries do therefore contain the adjacent symbol.

Correct disposal of product:

The adjacent symbol indicates that electrical and electric equipment may not be disposed of in domestic waste in the EU. Please use the returns and collection points of your local council or contact your dealer you purchased the product from. This prevents potentially harmful effects on the environment and health as a result of incorrect disposal. For further information, contact the respective department of your local council.

12. FCC STATEMENT

Operation is subject to the following two conditions:

- (1) This device may not cause harmful interference, and
- (2) This device must accept any interference received, including interference that may cause undesired operation.
- (3) This device has been evaluated to meet general RF exposure requirement. The device can be used in portable exposure condition without restriction.

Note:

This equipment has been tested and found to comply with the limits for a Class B digital device, pursuant to part 15 of the FCC Rules. These limits are designed to provide reasonable protection against harmful interference in a residential installation. This equipment generates, uses and can radiate radio frequency energy and, if not installed and used in accordance with the instructions, may cause harmful interference to radio communications. However, there is no guarantee that interference will not occur in a particular installation. If this equipment does cause harmful interference to radio or television reception, which can be determined by turning the equipment

off and on, the user is encouraged to try to correct the interference by one or more of the following measures:

- Reorient or relocate the receiving antenna.
- Increase the separation between the equipment and receiver.
- Connect the equipment into an outlet on a circuit different from that to which the receiver is connected.
- Consult the dealer or an experienced radio/TV technician for help.